

2:1

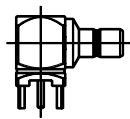

1:1

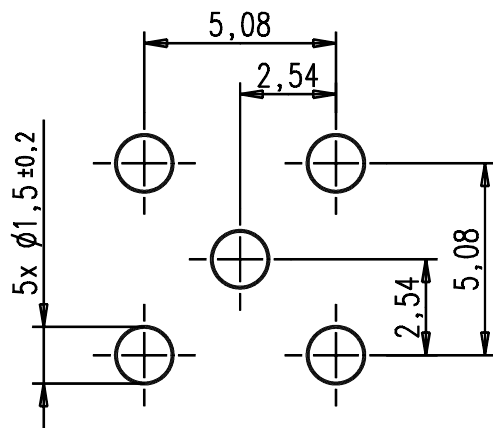

PCB - Layout

				general tolerance ISO 2768 mH		scale: <b>5:1</b>		
						Assembly instruction: Stripping dimension:		
					generate 18.08.76 checked Norm 32491	<b>Anbauwinkelstecker</b> <b>p.c.b. mount angle plug</b>		
XXX/00	b	Ueberarbeitung	19.12.00	Mayer		<b>11.1520.00'</b>		Rev. <b>b</b>
	a	Neue Ausgabe	16.01.78	Mayer				
nr.	rev.	alteration	date	name				