

Steckbereich nach IEC 169-10  
Mating area acc.to IEC 169-10

Kabelzuschnitt  
Stripping dimension

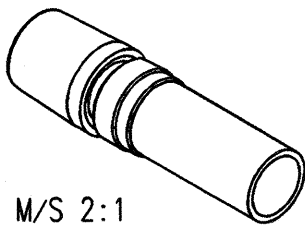
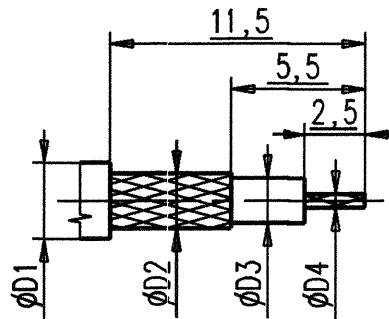

M/S 2:1

Fuer Kabel /  
For cable

Gr.	Type	ØD1 max.	ØD2 max.	ØD3 max.	ØD4 max.	ØD5	ØD6	ØD7	ØD8	Crimp Aussen/out	Crimp Innen/in
1											
2											
3	TZC 75024; BT 3002; 46121 H 133 PVC;	3,55	2,85	1,95	0,32	2,10	3,30	4,40	5,30	4,52	0,70
4											
5											

**IME CONNECTOR SYSTEMS GMBH**

general tolerance  
ISO 2768  
mH

scale: 5:1

Assembly instruction: M43  
Stripping dimension:

date 11.05.00 name Schuh  
generate  
checked  
Norm 24992

Kabelbuchse  
Cable mount jack



3039.11.2310.03'

Rev. a

ENTWURF a UEBERARBEITUNG 20.06.00 Schuh  
nr. rev. alteration date name