

# Product data sheet

IMS CONNECTOR SYSTEMS GmbH  
 Obere Hauptstrasse 30  
 D-79843 Löffingen  
 Postfach 1141  
 D-79840 Löffingen

Tel (+49) 7654 901-0  
 Fax (+49) 7654 901-199  
 Net: www.imscs.com  
 E-mail: sales@imscs.com

<b>Part Number: 4345.42.1520.001</b> <b>Description: SMA angle plug rev. pol.</b>		Revision: - Date: <b>24.08.2007</b> Signature: <b>Pözl N.</b> Page: 1 of 2	
<b>Design according to:</b>		<b>SMA reverse polarity</b>	<b>No IEC Standard</b>
<b>Electrical characteristics:</b>		colored value means: still under test target value	Picture
		<b>Value</b>	<b>Unit</b>
Impedance ( MIL-C- 39012B) Operating frequency up to		<b>50</b> <b>6</b>	[Ω] [GHz]
Return loss			
1 GHz		<b>34</b>	[dB]
2 GHz		<b>32</b>	[dB]
4 GHz		<b>19</b>	[dB]
6 GHz		<b>13</b>	[dB]
3rd. Order PIM product 2x43dBm		/	[dBc]
Insulation resistance		<b>10</b>	[GΩ]
Contact resistance			
Centre contact		<b>4</b>	[mΩ]
Outer contact		<b>2</b>	[mΩ]
Contact current max. (DC)		<b>2</b>	[A]
Operating voltage		<b>500</b>	[V]
Proof voltage		<b>1000</b>	[V]
			Remarks
			at 910MHz / at 1870 MHz
<b>Mechanical characteristics:</b>		<b>Value</b>	<b>Unit</b>
Engagement force		-	[N]
Separating force		-	[N]
Mating cycles		<b>&gt; 500</b>	

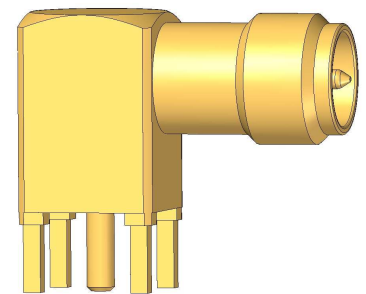

# Product data sheet

IMS CONNECTOR SYSTEMS GmbH  
Obere Hauptstrasse 30  
D-79843 Löffingen  
Postfach 1141  
D-79840 LöffingenTel (+49) 7654 901-0  
Fax (+49) 7654 901-199  
Net: www.imscs.com  
E-mail: sales@imscs.com

<b>Part Number:</b> 4345.42.1520.001 <b>Description:</b> SMA angle plug rev. pol.	<b>Revision:</b> -
	<b>Date:</b> 24.08.2007 <b>Signature:</b> Pölz N. <b>Page:</b> 2 of 2

<u>Material &amp; plating:</u>  Outer contact Centre contact Insulator	RoHS (2002/95/EC) conform	
	Material	Plating
	Brass	Cu + Ni + 0,8 / 0,2µm Au
	Brass	Ni + Ni-P + 0,15µm Au
	PTFE	-

<u>Environmental influences:</u>  Operating temperature range  Climatic sequence: 1. Dry heat 2. Damp heat, cyclic, 1 cycle 3. Cold 4. Damp heat, cyclic, 6 cycles  Solder profile:		Remarks
	-55°C up to +125°C Standard	
	IEC 60068-2-61 IEC 60068-2-2-Ba IEC 60068-2-30-Db IEC 60068-2-1-Aa IEC 60068-2-30-Db	
	-	

Notes:

<u>Update historie</u>			
Rev.	Date	Alteration	Signature